



# Smart riveter for drilling machine

Up to steel  
6.4 mm (1/4")



Up to steel  
M8 (5/16")



Screw, Rivet and Unscrew

A smart torque, assist the operator,  
reducing the effort of the hand





Page	Table of Contents
3	Greeting
4	Smart RiveDrill
5	How it Works
6	Working Stroke, Power and Speed
7	Which one? Old or modern.
8	Riveting cycle
9	RiveDrill HP Professional
10	RiveDrill E95H.20 y E95H.28
11	RiveDrill DIY. E95H, E10 and RD98
12	NutDrill for what?
13	NutDrill how it Works
14	Professional NutDrill ND and E95HND2
15	NutDrill step by step
16	All models RiveDrill and NutDrill
17	Packaging and weights
18	User conditions
19	In more than 60 countries
20	RiveDrill patented in US and more..



*Dear Clients, users and friends ;*

*Uniting and separating is the primordial action, which set the clock of time. From the first moment the elementary particles of matter and energy began to unite and to separate like pieces of puzzle, to form the Cosmos, the Earth and the Life.*

*Since the beginning of time humans have made connections; binding, sewing, weaving, gluing, stapling, buttoning, by clamping, nailing, screwing, welding, combining, mixing, blending, ionizing, alloying or riveting. Mixing colors, sounds, letters, words, or ideas, is also uniting or separating, as well as breathing or eating. Cut and paste; texts, vital organs such as the heart or liver, DNA, as well as connecting, to information, energy or transport networks, is basically to unite and separate. Currently in the Cosmos on Earth and in Life, the primordial action of uniting and separating, continues to be constant and incessant*

*In Maquinas Andrea, S.L. since 1966, more than 50 years ago, manufacture industrial fixing tools to join riveting. We had created Smart RiveDrill to reduce the effort, vibrations, cables and pipe for air compress. We do not manufacture manual or pneumatic tools any more. As unite riveting is important and its consequences too, we have develop our I+D+I, and had patented RiveDrill in USA and other countries, to offer to our clients, user and friends.*

*Kind regards, thank you.*

*Máquinas Andrea, S.L..*

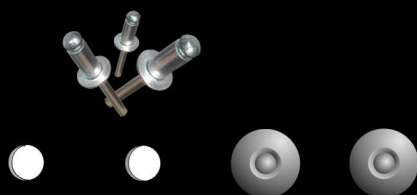

*Holes and rivets together forever*



*RiveDrill and drill together,  
the union makes the power*





# Smart RiveDrill

## Smart RiveDrill



**SMART RIVEDRILL  
TRANSFORM THE ENERGY OF  
A DRILL, IN TWO ENERGIES.**

**A RECTILINEAL PRESSEURE  
OF UNTIL 10.000 NEWTONS (1),**  
able to set the rivet of 6,4 mm  
diameter and a steel nut insert of  
M-8.

**And a Smart Torque (2),** that  
force the rivet to auto hold at the  
hole of the structure, reducing the  
effort of the reaction on the user  
hand, to an inferior press of 80  
Nw.

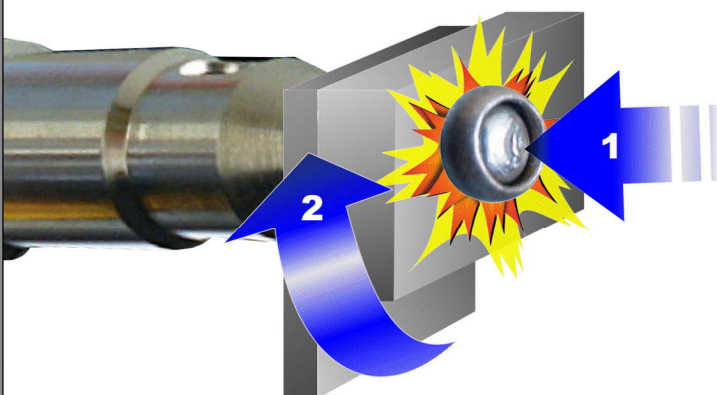

**The RIVETERS FOR DRILL RiveDrill and  
NutDrill** are manufacture to set rivets and nut  
inserts respectively, with several models, for  
professional and DIY use.



**YOU INSTALL AS A DRILL BIT, IN ANY MAKE OF BATTERY DRILL,** and also you can use it  
manually, using an axis wrench. Some models have a telescopic protector that cover the  
chuck of the drill. They have an easy maintenance system that can dismantle and substitute  
the user with the spare parts provided by the distributor or online.

**Smart RiveDrill** is the perfect tool of less than 600 grams, that complement a professional  
fastener equipment, to drill and rivet without effort, no cables, no compressors, no vibrations,  
no cramp on the fingers.





### Turning to the right, set the rivet.

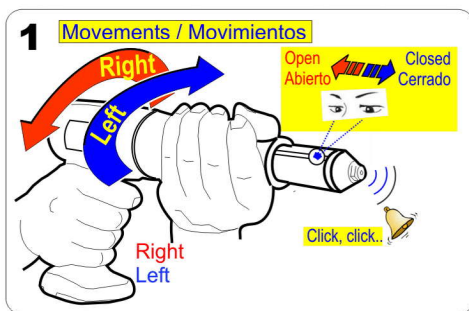

**1. Functioning.** When the drill turns to the right or to the left and RiveDrill is holding with the hand, to not turn, the inside mechanism jaw holder, is moved to the drill or to the top of the RiveDrill respectively, closing the control hole, that indicates initial position, and with the sound of the clutch of RiveDrill that confirm that the spindle is at the end of its run ( $Y_{MAX}$ ), and so the jaws are open to set the rivet.

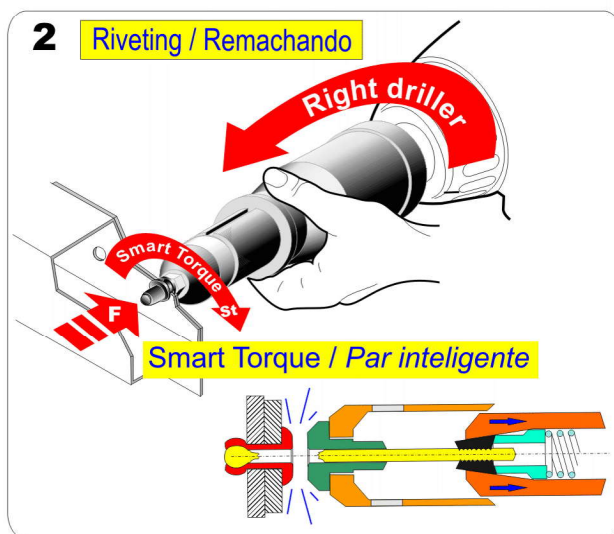

**2. To rivet.** Holding RiveDrill with the gloved hand to not turn, turns the drill to the right until is settled the rivet, and stop. Thanks to "Smart torque" the user hand only suffer a small reaction.

### Turning to the left, expel the mandrel.

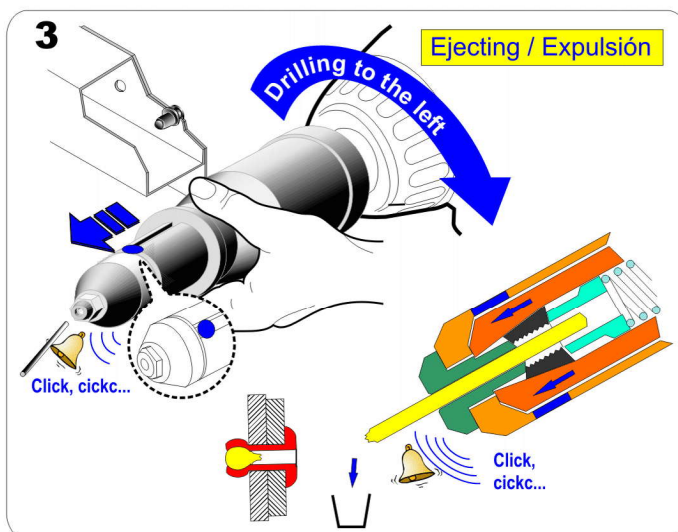

**3. To expel the mandrel.** Change the turn of the drill to the left, holding RiveDrill with the hand, to not turn, inclining down the RiveDrill to expel the mandrel, the hole control is closed and sound the clutch. Stop the drill. RiveDrill is ready for the next rivet, with the jaws (black on the draw) open.

**So Easy**

Holes and rivets set with the same drilling machine are united forever.

RiveDrill and drill join in the same fastener equipment, because Strength comes in numbers.



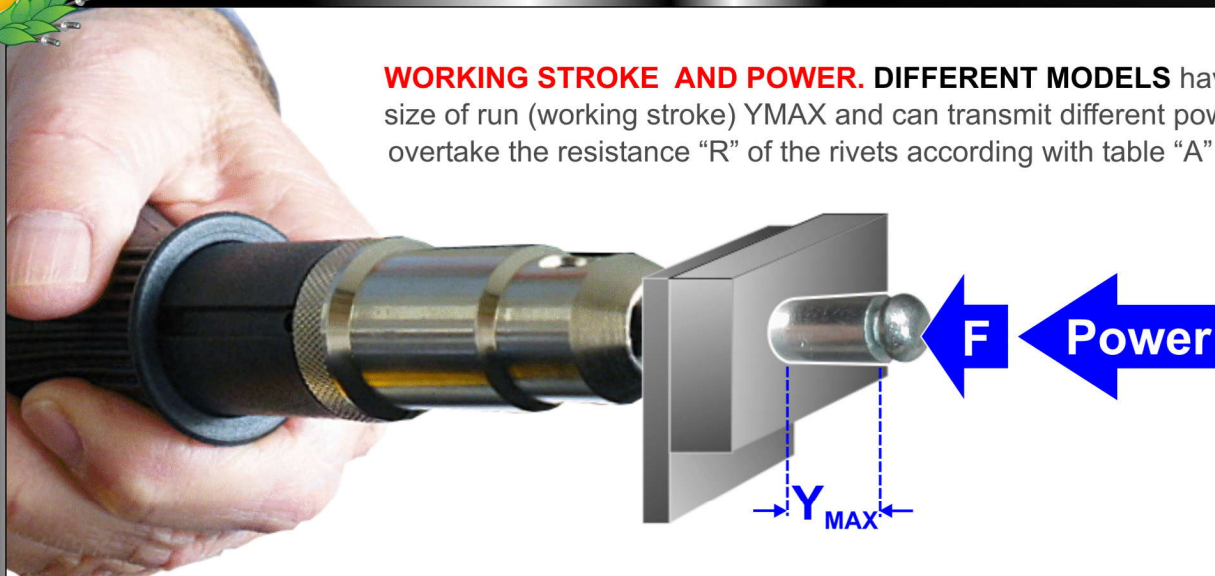

**WORKING STROKE AND POWER.** DIFFERENT MODELS have different size of run (working stroke) Y<sub>MAX</sub> and can transmit different power, to overtake the resistance "R" of the rivets according with table "A"

**RiveDrill ALWAYS RIVET IN ONE ACTION**, with run of work Y<sub>MAX</sub>

HP	E95H.28	E95H.20	E95H	E10	RD98
					
Y <sub>max</sub> = 30 mm = 1.18 in	Y <sub>max</sub> = 28 mm = 1.10 in	Y <sub>max</sub> = 20 mm = 0.79 in	Y <sub>max</sub> = 10 mm = 0.39 in		

Para remaches tipo; flor, ranurados, estructurales, etc. se necesitan siempre mas de 10 mm (0,39 pulgadas).

## SPEED AND DURABILITY FOR STRONG RIVETS.

Durability increase when speed of the drill decrease. The spindle of the module Rotor of RiveDrill, increase its durability, when reduce its wear, if the drill is used to slow revolutions. **Befit not to exceed the r.p.m. indicated on table "A". Green signal indicates inferior speed to 1400 r.p.m. Green signal with point yellow indicates less speed than 450 r.p.m..** Yellow signal with an X indicate minimum speed, up to the user, for small series of work that avoid the overheating, knowing that in that case there is an important wear on the Rotor Module, that could be substituted by the user when is wear away. Please see Maintenance and Spare parts section to get and substituted the spare parts. When the rivets are stronger it could be necessary to use gloves to hold the RiveDrill.

RiveDrill models, maximum speed of drilling machine and resistance typical of rivets, depending on material, diameter, and type Modelos RiveDrill, velocidad máxima de máquina taladradora y resistencia típica de remaches, según su material diámetro y tipo																										
A	Rivet material, diameter and strength Remaches, material, diámetro y resistencia		Stainless Steel A2 Acero Inox A2					Structural Steel DIN 1.5511 Acero Estructural DIN 1.5511		Standard Steel DIN 1.0213 Estandar Acero DIN 1.0213							Aluminium 3.5% Mg Aluminio 3,5% Mg					Aluminium 2.5% Mg Aluminio 2,5% Mg			Rivet Type	
			Diameter (in) Diámetro (mm)	1/4	3/16	5/32	1/8	3/32	1/4	3/16	1/4			3/16	5/32	1/8		1/4	3/16	5/32	1/8	3/32	1/4	3/16		5/32
		6,4	4,8	4,0	3,2	2,4	6,4	4,8	6,4	6,0	5,0	4,8	4,0	3,2	3,0	6,4	4,8	4,0	3,2	2,4	6,4	4,8	4,0	3,2		
R	Rivet strength (Newton)(*) Resistencia remache (*)		9000	5800	3500	2500	1250	8800	3900	5700	4800	4000	3100	2200	1200	1100	4800	2600	1800	1100	550	4000	2300	1400	980	Peeled, Flor
Y <sub>MAX</sub> (mm)			30	28	20	10	10	30	28	20	10	10	30	28	20	10	30	28	20	10	10	30	28	20	10	
	RiveDrill HP		✗	●	●	●	●	✗	●	●	●	✗	●	●	●	●	●	●	●	●	●	●	●	●	●	●
	RiveDrill E95H.28									●	●	✗	●	●	●	●	●	●	●	●	●	●	●	●	●	●
	RiveDrill E95H.20											✗	●	●	●	●	●	●	●	●	●	●	●	●	●	●
	RiveDrill E95H												●	●	●	●	●	●	●	●	●	●	●	●	●	●
	RiveDrill E10																●	●	●	●	●	●	●	●	●	●
	RiveDrill RD98																		●	●	●	●	●	●	●	●
Maximum speed Máxima velocidad			● 1400 r.p.m					● 450 r.p.m.					✗ Consulting / Consultando													

(\*) Typical values of rivet strength may vary, depending on countries or manufacturers. The values given here are only approximate.

(\*) Los valores típicos de resistencia de los remaches pueden variar según países o fabricantes. Los valores señalados aquí son solo aproximados.



Drill not Included



### Remachadoras manuales o Smart RiveDrill Hand Riveters Tool (Rivet Gun), or Smart RiveDrill



**Wich?**  
**¿Cual?**



Maximum rivet capability Steel DIN 1.0213 rivet 6,4 mm diameter, with resistance 5.700 Newtons and effort on operator hand 80 to 150 Newtons, in one action with 30 mm working stroke, and with a soft break of the mandrel, without effort. Weight of the tool less than 600 grams.

Maximum capability for Aluminum 3,5% Mg, 4,8 mm diameter, with resistance 3.100 Newtons and hand operator effort 300 Newtons, with two minimum, with 4 or 5 mm useful each, with sudden break of the mandrel of the rivet and strong pressure on the fingers. Less than 600 grams weight of the tool.

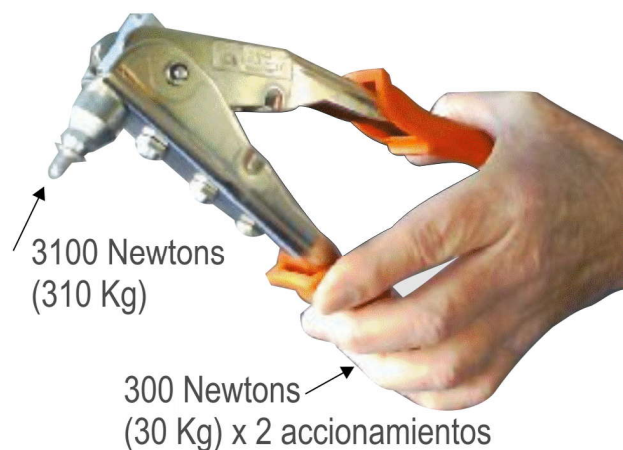

**That is way we do not manufacture manual rivetting tools any more.**





### MANNUAL RIVETER REQUIRE SEVERAL ACTIONS

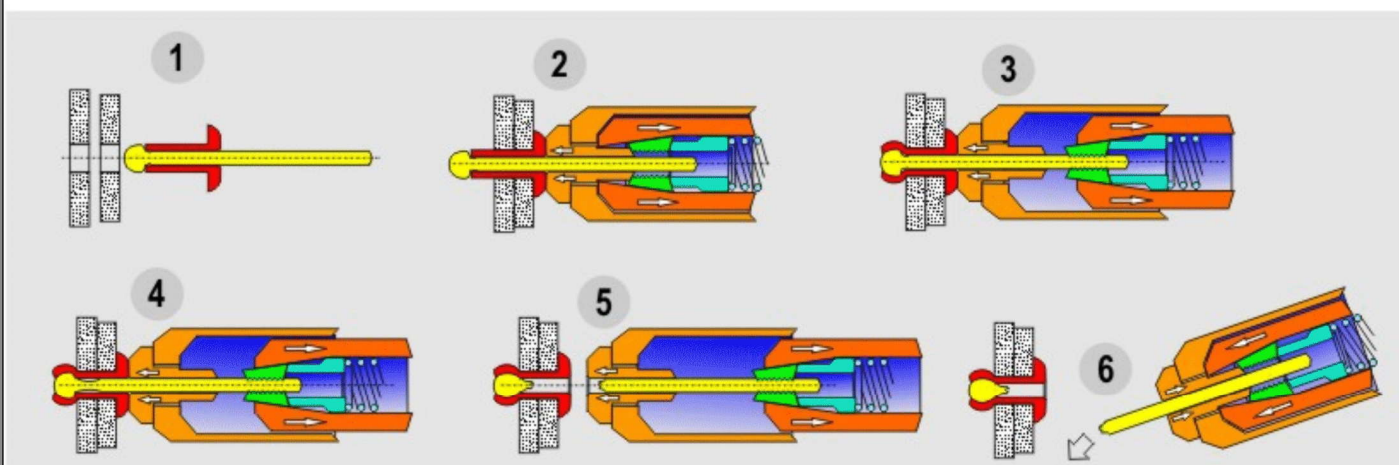

**AT POINT 3 AND 4 MANY EFFORT  
AND AT POINT 5 PRODUCE A GREAT REACTION**

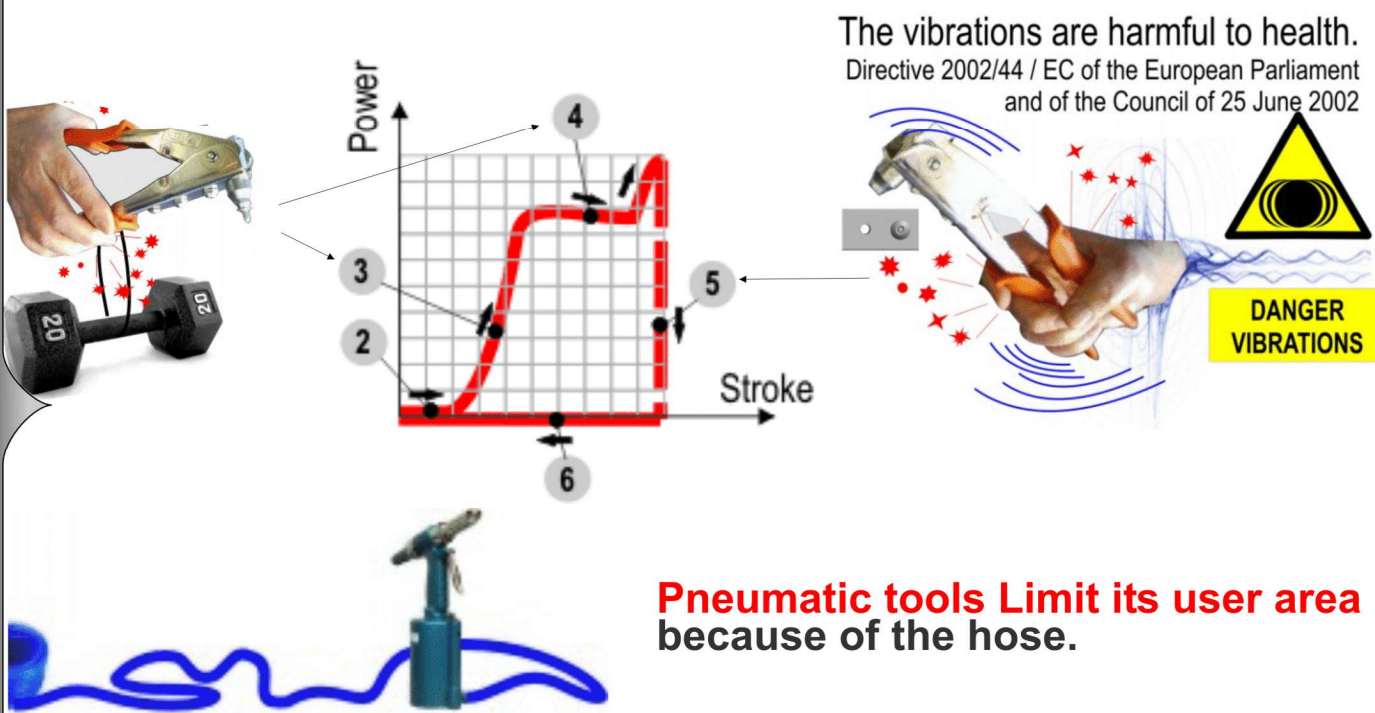

**RiveDrill Rivet in any place**, without effort, without vibrations,  
without hose, without compressor, in just one Action with a  
Battery (cordless) drill.



**Outdated**







# Smart RiveDrill HP Professional



## RiveDrill HP Professional

Capability until resistance of rivets 5800 Newtons (580 Kg). Maximum WORKING STROKE 30 mm.

Steel and rubber Body. Hexagonal axis of 8 mm with spindle of 9 mm. Three jaws. Net weight 582 gr. Gross weight 700 gr. Sizes 175 x 65mm. Sizes of nickel plated nosepiece; D22mm x 26 mm + D 25 mm x 34 mm. 4 nosepieces included. For rivet diameter 3,0 - 3,2 - 4,0 - 4,8 - 5,0 and 6,4mm (1/8-5/32-3/16, 1/4in). Set the rivet in one action. It is an excellent professional tool, very powerful and with good working stroke, although its weight is less than 600 grams, available for steel rivets 6,4 mm, included peel rivets with a fine guide that goes well into narrow holes. The automatic pair (smart torque) that produced, reduce the effort on the operator hand. The maintenance can be easily made by the user as it is indicated at the end of the page. On the unitary or round boxes are user manual. You can see videos online. Professional use with battery (cordless) drill at maximum speed indicated on Table "A", depending on materials and diameters of the rivets. Because of its run, you can use peel rivets, structural, grooved or watertight rivets. Distributors can purchase in boxes of 6 units, size 26 x 20 x 16 h (cm) of 5 kg each or in packaging of 24 units of sizes 42 x 28 x 36 (cm) and 21 kg.



## RiveDrill HP Professional.

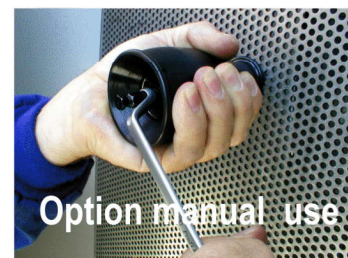
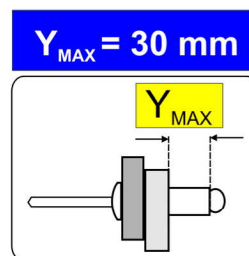

A	Rivet material, diameter and strength	Stainless Steel A2 Acero Inox A2					Structural Steel DIN 1.5511 Acero Estructural DIN 1.5511	Standard Steel DIN 1.0213 Estandar Acero DIN 1.0213							Aluminium 3.5% Mg Aluminio 3,5% Mg					Aluminium 2.5% Mg Aluminio 2,5% Mg				Rivet Type	RiveDrill model
		1/4	3/16	5/32	1/8	3/32	1/4	3/16	1/4			3/16	5/32	1/8		1/4	3/16	5/32	1/8	3/32	1/4	3/16	5/32	1/8	
	Diameter (in) Diámetro (mm)	6,4	4,8	4,0	3,2	2,4	6,4	4,8	6,4	6,0	5,0	4,8	4,0	3,2	3,0	6,4	4,8	4,0	3,2	2,4	6,4	4,8	4,0	3,2	
	Rivet strength (Newton) Resistencia remache	9000	5800	3500	2500	1250	8800	3900	5700	4800	4000	3100	2200	1200	1100	4800	2600	1800	1100	550	4000	2300	1400	980	
	Max Drilling Speed (r.p.m.) Velocidad máxima del taladrador (r.p.m.)	✖	●	●	●	●	✖	●	●	●	●	●	●	●	●	●	●	●	●	●	●	●	●	●	●
						1400 r.p.m.			450 r.p.m.			450 r.p.m.	450 r.p.m. and short series only / r.p.m. y solo series cortas.										✖		

## Spare Parts RiveDrill HP

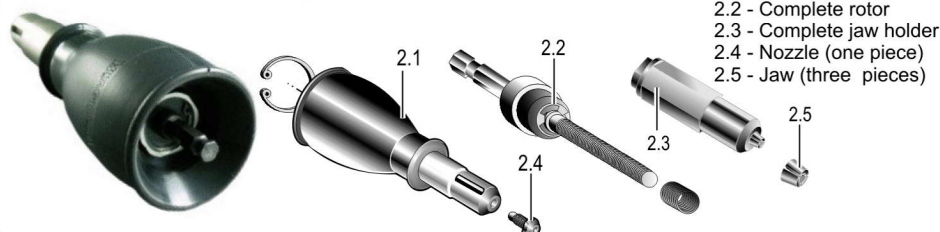

**Maintenance.** The user can dismantle easily the elastic washer on the axis with needle nose pliers, to substituted ; Rotor (2.2), Tractor or Jaw holder (2.3) or if prefer to change just the jaws (2.5), or the nosepiece (2.4), that can purchase your distributor or online. Durability increase if the speed is reduced.





### RiveDrill E95H.28

**Capability until resistance of rivets 2600 Nw (260 kg). Maximum WORKING STROKE 28 mm.**

Steel and polyamide Body with fiber glass. Nickel plated guide. Spindle of 7 mm. Telescopic protector for the hand. Two jaws. Net weight 360 gr. Gross weight 477 gr. Sizes 175 x 60mm. Sizes of nickel plated nosepiece; D22mm x 27 mm + D 25 mm x 16 mm + D28 mm x 57 mm. 3 nosepieces included. For rivet diameter 3,0 - 3,2 - 4,0 - 4,8 - 5,0 mm (1/8-5/32-3/16 in). Set the rivet in one action. The maintenance can be easily made by the user as it is indicated at the end of the page. On the unitary or round boxes are user manual. You can see videos online. Professional use with battery (cordless) drill a maximum speed indicated on Table "A", depending on materials and diameters of the rivets. Because of its run, you can use peel rivets, structural, grooved or watertight rivets. Distributors can purchase in boxes of 6 units, size 26 x 20 x 16 h (cm) of 3,5 kg each or in packaging of 24 units of sizes 42 x 28 x 36 (cm) and 14 kg.

### RiveDrill E95H.28



### RiveDrill E95H.28



**Y<sub>MAX</sub> = 28 mm**

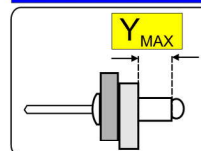

Protector de Mano Deslizante en E20 & E28

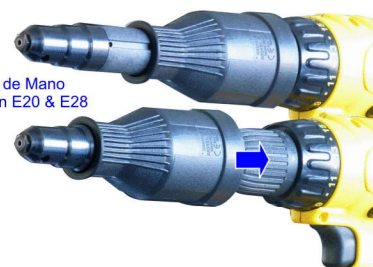

### RiveDrill E95H.20

**Capability until resistance of rivets 2600 Nw (260 kg). Maximum WORKING STROKE 20 mm**

Steel and polyamide Body with fiber glass. Spindle of 7 mm. Telescopic protector for the hand. Two jaws. Net weight 356 gr. Gross weight 473 gr. Sizes 175 x 60mm. Sizes on front guide; D22mm x 27 mm + D 25 mm x 16 mm + D28 mm x 57 mm. 3 nosepieces included. For rivet diameter 3,0 - 3,2 - 4,0 - 4,8 - 5,0 mm (1/8-5/32-3/16 in). Set the rivet in one action. Professional use. You can see videos online. Professional use with battery (cordless) drill at maximum speed indicated on Table "A", depending on materials and diameters of the rivets. Because of its run, you can use peel rivets, structural, grooved or watertight rivets. On the unitary or round boxes are user manual. Distributors can purchase in boxes of 6 units, size 26 x 20 x 16 h (cm) of 3,5 kg each or in packaging of 24 units of sizes 42 x 28 x 36 (cm) and 14 kg.

### RiveDrill E95H.20



### RiveDrill E95H.20



**Y<sub>MAX</sub> = 20 mm**

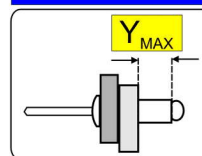

A Rivet material, diameter and strength	Stainless Steel A2 Acero Inox A2					Standard Steel DIN 1.0213 Estandar Acero DIN 1.0213					Aluminium 3.5% Mg Aluminio 3,5% Mg					Aluminium 2.5% Mg Aluminio 2,5% Mg					Rivet Type
	1/4	3/16	5/32	1/8	3/32	1/4	3/16	5/32	1/8	3/32	1/4	3/16	5/32	1/8	3/32	1/4	3/16	5/32	1/8	3/32	
Diameter (in)	6,4	4,8	4,0	3,2	2,4	6,4	4,8	4,0	3,2	2,4	6,4	4,8	4,0	3,2	2,4	6,4	4,8	4,0	3,2	2,4	Peeled, Flor
Rivet strength (Newton) Resistencia remache	9000	5800	3500	2500	1250	8800	3900	5700	4800	4000	3100	2200	1200	1100	4800	2600	1800	1100	550	4000	
Max Drilling Speed (r.p.m.)																					
Velocidad máxima del taladrador (r.p.m.)						1400 r.p.m.		450 r.p.m.			450 r.p.m.										



### Spare Parts RiveDrill

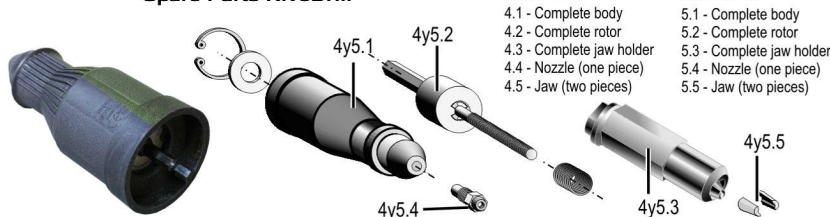

### Maintenance.

The user can dismantle easily the elastic washer on the axis with needle nose pliers, to substituted ; Rotor (4.2), Tractor of Jaw holder (4.3), (5.3) or if prefer to change just the jaws (4.5), (5.5), or the nosepiece (4.4)(5.4), that can purchase your distributor or online.

Durability increase if the speed is reduced





## RiveDrill E95H

**Capability until resistance of rivets 2400 Nw (240 kg). Maximum Working Stroke 10 mm**

Polyamide Body with fiber glass. Spindle of 7 mm. Telescopic protector for the hand. Two jaws. Net weight 293 gr. Gross weight 410 gr. Sizes 145 x 60mm. Sizes on front guide; D28mm x 64. 3 nosepieces included. For rivet diameter 3,0 - 3,2 - 4,0 - 4,8 mm (1/8-5/32-3/16 in). Set the rivet in one action. DIY use. Maximum speed of the battery (cordless) drill for materials and diameter of the rivets indicated on Table "A". Do not use with peel rivets, structural, grooved or watertight rivets. On the unitary or round boxes are user manual. Distributors can purchase in boxes of 12 units, size 26 x 20 x 16 h (cm) of 5 kg each or in packaging of 48 units of sizes 42 x 28 x 36 (cm) and 21 kg. Above picture shows the telescopic protector of the hand.

### RiveDrill E95H

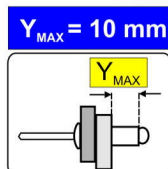

### RiveDrill E95H



## RiveDrill E10

**Capability until resistance of rivets 1800 Nw (180 kg). Maximum Working Stroke 10 mm**

Polyamide Body with fiber glass. Spindle of 7 mm. Two jaws. Net weight 230 gr. Gross weight 270 gr. Sizes 140 x 38mm. Sizes on front guide; D28mm x 92. 3 nosepieces included. For rivet diameter 3,0 - 3,2 - 4,0 - 4,8 mm (1/8-5/32-3/16 in). DIY use for materials and diameter of the rivets indicated on Table "A". On the unitary or round boxes are user manual 26 x 20 16 cm with 14 units for distributors and weight 4,5 Kg or 42 x 28 x 36 cm with 56 units and weigh 18 kg.

### RiveDrill E10

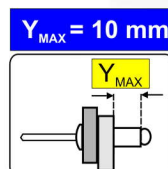

### RiveDrill E10



## RiveDrill RD98

**Capability just for soft rivets of 4 mm. Maximum Working Stroke 10 mm.**

Polyamide Body with fiber glass. Two jaws. Net weight 189 gr. Gross weight 229 gr. Sizes 140 x 38mm. Sizes on front guide; D24mm x 95. Just one nosepieces not dismantle for 4 mm (5/32in). DIY use for materials and diameter of the rivets indicated on Table "A". On the unitary or round boxes are user manual 26 x 20 16 cm with 14 units for distributors and weight 3,7 Kg or 42 x 28 x 36 cm with 56 units and weigh 15,5 kg.

### RiveDrill RD98

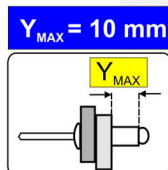

### RiveDrill RD98



A	Rivet material, diameter and strength	Stainless Steel A2 Acero Inox A2					Structural Steel DIN 1.5511 Acero Estructural DIN 1.5511	Standard Steel DIN 1.0213 Estandar Acero DIN 1.0213					Aluminium 3.5% Mg Aluminio 3,5% Mg					Aluminium 2.5% Mg Aluminio 2,5% Mg				Rivet Type	RiveDrill model			
		1/4	3/16	5/32	1/8	3/32	1/4	3/16	1/4			3/16	5/32	1/8		1/4	3/16	5/32	1/8	3/32	1/4			3/16	5/32	1/8
Diameter (in) Diámetro (mm)		1/4	3/16	5/32	1/8	3/32	1/4	3/16	1/4	6,0	5,0	3/16	5/32	1/8	3,0	1/4	3/16	5/32	1/8	3/32	1/4	3/16		5/32	1/8	Peeled,  Flor
Rivet strength (Newton) Resistencia remache		9000	5800	3500	2500	1250	8800	3900	5700	4800	4000	3100	2200	1200	1100	4800	2600	1800	1100	550	4000	2300		1400	980	
Max Drilling Speed (r.p.m.) Velocidad máxima del taladrador (r.p.m.)																										
											</															

### Spare Parts RiveDrill E95H

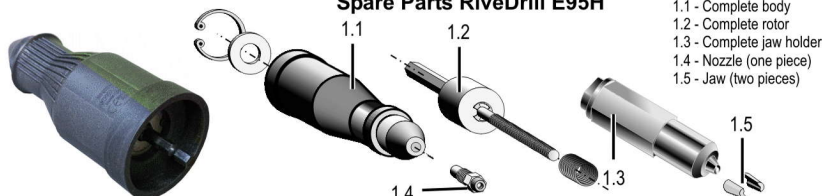

### Maintenance.

The user can dismantle easily the elastic washer on the axis with needle nose pliers, to substituted ; Rotor (1.2), Tractor of Jaw holder (1.3) or if prefer to change just the jaws (1.5) that can purchase your distributor or online.

Durability increase if the speed is reduced





# Smart RiveDrill NutDrill



**To set nut inserts in thin walls and produce dismantle fasteners**

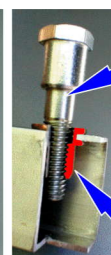

Tornillo  
desmontable

Pared delgada

Tuerca  
remachada

## NutDrill screw, rivet and unscrew the nut insert.

Screw the aluminum or steel nut insert ( until M-8),  
rivet (with power until 8400 Newtons) and unscrew.  
So the nut insert is fasten on a thin metal sheet.

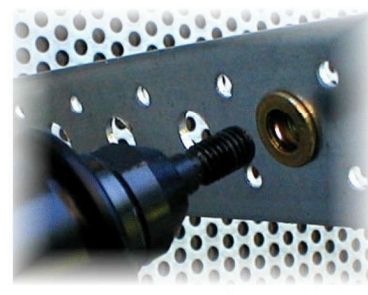

## NutDrill ND Professional.



**+5** mandriles



## Substitution of mandrels

of any thread, Metric (until Steel M-8) or Ameriza size ( until steel 5/16")







## NutDrill install as a drill bit

Select the guide and mandrel size on NutDrill that you want to work with and put the drill on the slow speed with minimum torque, or similar to the following table, to increase it step by step until the nut insert is settled correctly. Before that read completely the user manual included with the unit.

Rosca tuerca	M3	M4	M5	M6	M8
Marca torque #	2	4	6	7	8

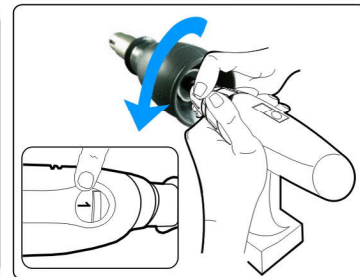
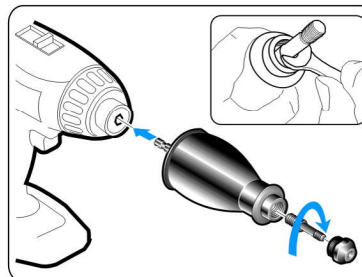

## Four movement for NutDrill

NutDrill makes four movement, able to screw, rivet, avoid the pressure of the nut insert and unscrew the nut insert. NutDrill transform the energy of 8400 Nw (840 Kg, for steel M-8 nut inserts), with a minimum reaction of the operator hand, that is supported, always that is settled on structural holes, by the automatic torque ( smart torque) produced by NutDrill. The user can experience, following the user manual, included on each unit, the four movements, on air, avoiding that the mandrel hit the end of the run, of around 9 mm approximately.

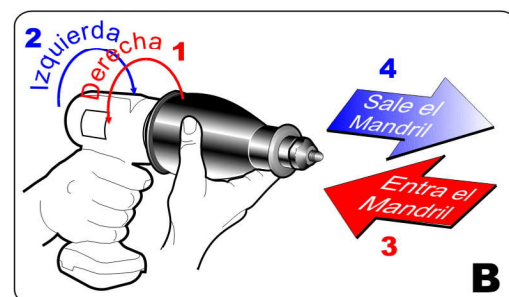
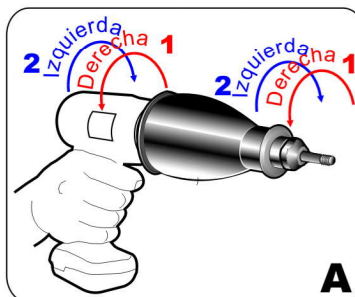

**A.** When the battery (cordless) drill turns to the right or to the left by itself, without holding with the hand, as on Figure A, NutDrill also turns freedom to the right and left respectively. Those two movements are applied to screw and unscrew the nut insert on the mandrel.

**B** But when NutDrill is holding with the hand to not turn, as on figure B, To the right (1) or to the left(2) the mandrel screw into (3) or unscrew forward (4) respectively. And make it strongly. These two movements are applied to set the rivet pressure (3) or to avoid the pressure (4) before unscrewing the nut insert. There are tutorial video on internet in several languages. The user can experience, following the user manual, included on each unit, the four movements, on air, out of the hole, to fix the torque necessarily for the nut insert is using. On figure C, set the nut insert turning to the right while the NutDrill is holding with the gloved hand to not turn, helped by the "smart torque of NutDrill" until the clutch sounds strongly selected previously. Stop and change the turn of the drill to the left. (D) Turn to the left holding with the hand to avoid the pressure, during two seconds and (E) release the hand to turn NutDrill freedom and unscrew. Stop. NutDrill is ready for the next nut insert.

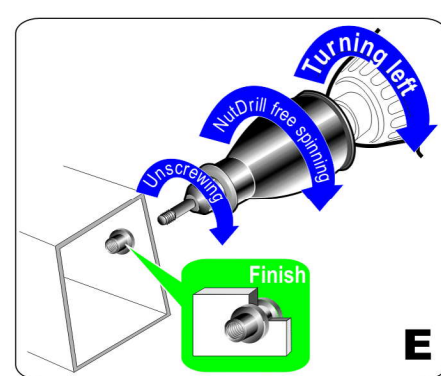
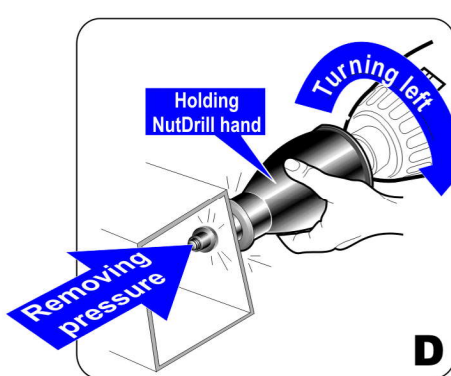
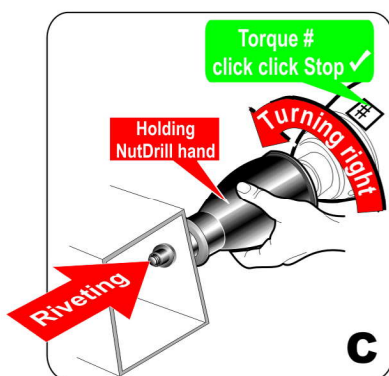

## User Maintenance.

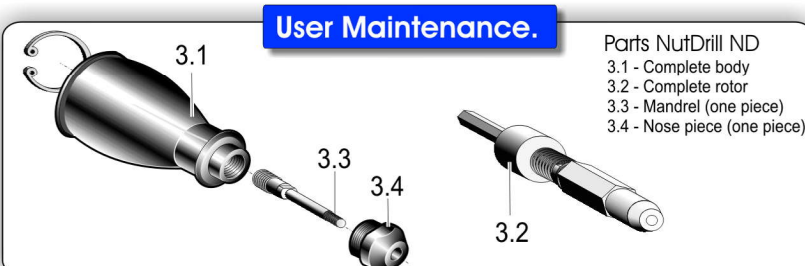

## Maintenance.

The user can dismantle easily the elastic washer on the axis with needle nose pliers, to substituted ; Rotor (3.2), Tractor of Jaw holder (3.4) and the mandrels (3.3) of the size of thread, metric or American, that can purchase your distributor or online. Durability increase if the speed is reduced if the torque is selected correctly to not overload the mandrels. It is important not hit the end of the run of the mandrels ( around 9 mm).



### NutDrill ND

Capability until resistance of 9000 Newton (900kg) as Table. Maximum Working Stroke 8 mm.

Professional Use. Steel and rubber body. Net weight 511 grams. Gross weight 828 grams. Sizes 165 x 65 mm. For Steel and aluminum nut inserts of M-3, M-4, M-5, M-6 and M-8 or its equivalent in American sizes. UNC 6-32, UNC 8-32, UNC 10-24, UNF 10-32, W1/4" and W5/16"-18. Included 5 set of mandrels and guides. Also can be supplied without mandrels, just with those you need. Unitary carton or round box with the user manual. Distributors can purchase 6 units in boxes of 20 x 26 x 16 (cm) and weigh 5,5 kg or packaging of 24 units with 40 x 28 x 36 cm and weight 22 kg. Used in any make of battery (cordless) drill with minimum speed and Torque regulated previously. There are tutorial videos in several languages.

NutDrill ND



### NutDrill ND Professional.



5



Material	Inox A2						Acero							Aluminio			
Rosca	M10	M8	M6	M5	M4	M3	M12	M10	M8	M6	M5	M4	M3	M8	M6	M5	M4
Resistencia (Newton)	13400	11300	9600	7300	4800	2700	14700	11000	8400	6500	5100	3900	2400	6000	5000	4400	3600
OK																	

### NutDrill E95H.ND2

Capability until resistance of 9000 Newton (900kg) as Table. Maximum Working Stroke 8 mm.

DIY Use. Steel and Polyamide body. With slide protector. Net weight 361 grams. Gross weight 678 grams. Sizes 165 x 60 mm. For Steel and aluminum nut inserts of M-3, M-4, M-5, M-6 and M-8 or its equivalent in American sizes. UNC 6-32, UNC 8-32, UNC 10-24, UNF 10-32, W1/4" and W5/16"-18. Included 5 set of mandrels and guides. Also can be supplied without mandrels, just with those you need. Unitary carton or round box with the user manual. Distributors can purchase 6 units in boxes of 20 x 26 x 16 (cm) and weigh 4,5 kg or packaging of 24 units with 40 x 28 x 36 cm and weight 19 kg. Used in any make of battery (cordless) drill with minimum speed and Torque regulated previously. There are tutorial videos in several languages.

NutDrill E95H.ND2



### NutDrill E95H.20



5



Material	Inox A2						Acero							Aluminio			
Rosca	M10	M8	M6	M5	M4	M3	M12	M10	M8	M6	M5	M4	M3	M8	M6	M5	M4
Resistencia (Newton)	13400	11300	9600	7300	4800	2700	14700	11000	8400	6500	5100	3900	2400	6000	5000	4400	3600
OK																	

### User Maintenance.

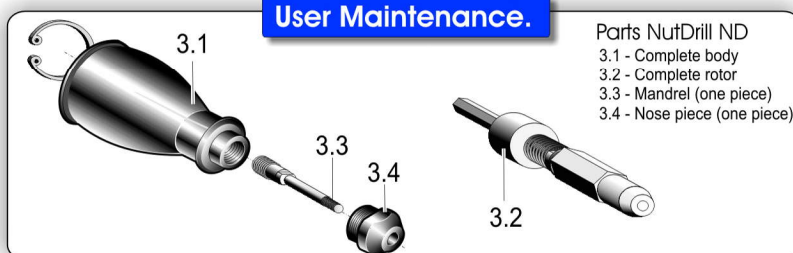

Parts NutDrill ND  
3.1 - Complete body  
3.2 - Complete rotor  
3.3 - Mandrel (one piece)  
3.4 - Nose piece (one piece)

### Maintenance.

The user can dismantle easily the elastic washer on the axis with needle nose pliers, to substituted ; Rotor (3.2), Tractor of Jaw holder (3.4) and the mandrels (3.3) of the size of thread, metric or American, that can purchase your distributor or online. Durability increase if the speed is reduced if the torque is selected correctly to not overload the mandrels. It is important not hit the end of the run of the mandrels ( around 8 mm).





### How are the four movements

1-Installing

2-To the left and holding with the hand the mandrel leaves

3- Release and stop to not hit. Try on the air the four movements of the mandrel. Forward, backward turning to the right and left holding and releasing the NutDrill.

4- Screw

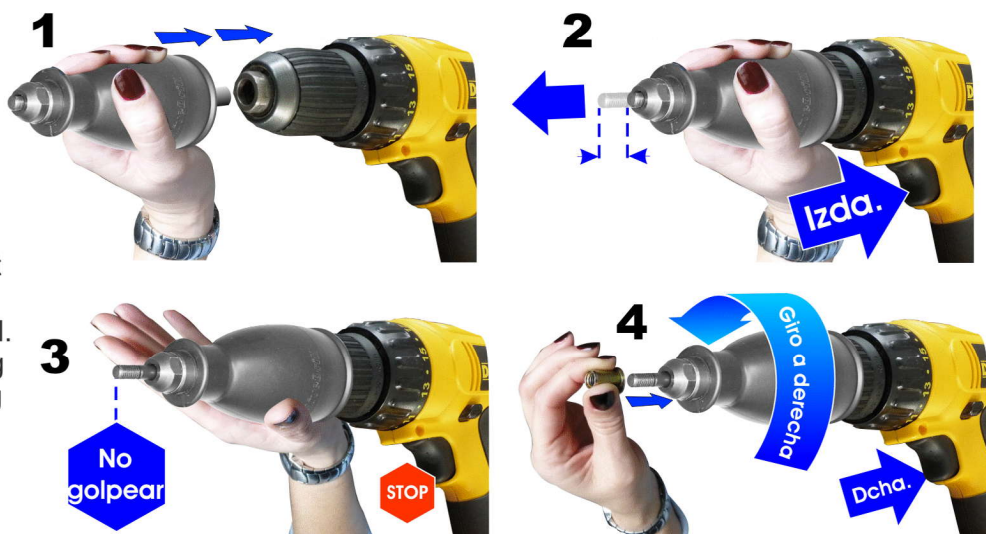

### Experiencing the power of NutDrill

5- Try on the air, the best "Torque" if necessary. Listen to the sound of the clutch to set the nut insert

6- Look at the nut insert settled and increase the "torque" if necessary. Listen to the strong sound of the clutch when acting the "torque" and stop.

7- Avoid the pressure, holding with the hand to not turn, ONLY two seconds and

8- ... then release the hand to unscrew the nut insert we had tried on air to test the "torque"



Drilling machine not included

### USING NutDrill

A-Screw as on (4), turn to the right holding strongly with the hand until you listen to the strong noise of the clutch with the torque of the drill. While the "Smart torque" of NutDrill help on the reaction of the hand. Stop

B- Change the turn of the drill to the left, holding 2 seconds like (7) and release the hand while still turn until unscrew completely from the nut inset settled





# Smart RiveDrill

## All the model



RiveDrill HP



RiveDrill E95H.28



RiveDrill E95H.20

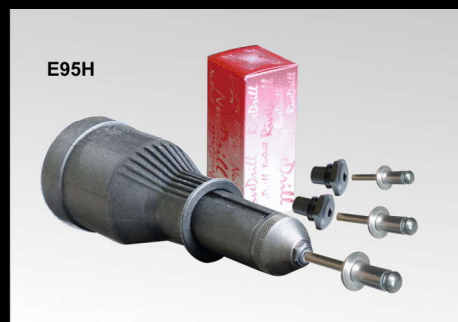

E95H



RiveDrill E10



RiveDrill RD98

A

RiveDrill models, maximum speed of drilling machine and resistance typical of rivets, depending on material, diameter, and type

Modelos RiveDrill, velocidad máxima de máquina taladradora y resistencia típica de remaches, según su material diámetro y tipo

Rivet material, diameter and strength

Remaches, material, diámetro y resistencia

Stainless Steel A2

Acero Inox A2

Structural Steel DIN 1.5511

Acero Estructural DIN 1.5511

Standard Steel DIN 1.0213

Estandar Acero DIN 1.0213

Aluminium 3.5% Mg

Aluminio 3,5% Mg

Aluminium 2.5% Mg

Aluminio 2,5% Mg

Rivet Type

Diameter (in)

Diámetro (mm)

1/4

3/16

5/32

1/8

3/32

1/4

3/16

1/4

3/16

5/32

1/8

1/4

3/16

5/32

1/8

3/32

1/4

3/16

5/32

1/8

6,4

4,8

4,0

3,2

2,4

6,4

4,8

6,4

6,0

5,0

4,8

4,0

3,2

3,0

6,4

4,8

4,0

3,2

2,4

6,4

4,8

4,0

3,2

R

Rivet strength (Newton)(\*)

Resistencia remache (\*)

9000

5800

3500

2500

1250

8800

3900

5700

4800

4000

3100

2200

1200

1100

4800

2600

1800

1100

550

4000

2300

1400

980

Y MAX

(mm)

30

28

20

10

10

10

RiveDrill HP

RiveDrill E95H.28

RiveDrill E95H.20

RiveDrill E95H

RiveDrill E10

RiveDrill RD98

Maximum speed

Máxima velocidad

1400 r.p.m

450 r.p.m.

Consulting / Consultando

(\*) Typical values of rivet strength may vary, depending on countries or manufacturers. The values given here are only approximate.

(\*) Los valores típicos de resistencia de los remaches pueden variar según países o fabricantes. Los valores señalados aquí son solo aproximados.



NutDrill ND



NutDrill E95H.ND2

Material	Inox A2						Acero							Aluminio			
Rosca	M10	M8	M6	M5	M4	M3	M12	M10	M8	M6	M5	M4	M3	M8	M6	M5	M4
Resistencia (Newton)	13400	11300	9600	7300	4800	2700	14700	11000	8400	6500	5100	3900	2400	6000	5000	4400	3600
NutDrill ND			●	●	●	●			●	●	●	●	●	●	●	●	●
NutDrill ND2				●	●	●				●	●	●	●	●	●	●	●





### RiveDrill Empaquetados y pesos Packaging and weights

#### Boxes Cajas o botes de cartón



Unit weight (Kgs)

HP	E28	E20	E95H	E10	RD98	ND	ND2
0.75	0.53	0.53	0.38	0.30	0.25	0.75	0.58

#### Inner boxes Cajas interiores



Measures  
26 x 20 x 16 cm

Contenido (unid.)  
Units inner  
boxes

Weight each inner  
boxes (Kgs)

6	6	6	12	14	14	6	6
4.70	3.30	3.30	4.70	4.40	3.70	4.70	3.60

#### Outer packaging Embalajes exteriores



Measures  
42 x 28 x 36 cm

Contenido (unid.)  
Inner boxes in each  
outer packaging

Weight each outer  
packaging (Kgs)

4	4	4	4	4	4	4	4
19.30	13.90	13.80	19.30	18.10	15.30	19.30	15.10

### RiveDrill

E95H in Blister pack (37 x 24 cm)  
palletizing



4 Blister in Inner packaging (25 x 23 x 12 cm) - 5 Inner packaging in Outer packaging (61 x 25 x 23 cm) - 30 Outer packaging in a Pallet  
**Palelet 600 RiveDrill (Blister) approximate weight 300 Kgs.**



## Security AND USER CONDITIONS

### Security

Use gloves on the operator hand that is holding RiveDrill or NutDrill and glasses and safety Wearing shoes. Work in correct and stable position. Keep the work area clear, without children or person around, external to work. Residual mandrels must be collected in suitable containers and deposited in containers classified according to environmental standards. Residual mandrels in the ground can cause slips and falls. Be aware of the reaction in the hand holding RiveDrill or NutDrill, which may increase if overheated or overloaded. In this case stop, cool and check the "Terms of Use"

### RiveDrill - User conditions

- a) RiveDrill must be used only with reversible battery (cordless) drill, and with speed indicated on table "A". Drill Not included.
- b) Do not get over maximum size "Y"
- c) Use the correct nosepiece
- d) Stop immediately after break the mandrel of the rivet.
- e) If increase the reaction on the hand, stop and left cool.

### NutDrill - User conditions

- a) NutDrill must be used only in reversible battery(cordless) drill, at minimum slow speed and with torque. Drill not included
- b) Test on the air with minimum speed without hitting to the end of the run
- c) Use always correct size of mandrel and guide.
- d) Determinate experimentally, rivetting on the air, before begin the work, the torque or the nut insert you are going to use.
- e) If increase the reacción on the hand, stop and left cool.

## Warranty and Declaration of Conformity

### Quality and Warranty

All our product had been submit to a final quality control on the 100% of the units of sale. In case of see any manufacture defect please contact with your distributor providing the purchase invoice. The defect produced because of no applying the "User conditions" that are included on the user manual, incorrect use, overheating or overloading or normal wear, also with the delivery and back charges, are excluded of the warranty. Our warranty is only refer to RiveDrill products. In any case to other product or the person which use them. Warranty is repair, substitute or return, depends on the cases

### Declaration of Conformity

Maquinas Andrea, S.L. with address in C/ Islas Cies 61, 28035 Madrid ( Spain) Declare the RiveDrill satisfies the requirements of Directive 2006/42 / EC in accordance with Annex V of the European Parliament and of the Council of 17 May 2006. RiveDrill is designed to be powered by a battery drill (not included) only after conformity is determined of the finished product with the requirement of the directive  
1-Julio-2017  
Administradora.  
Nuria Pérez



## Maintenance and repair

RiveDrill and NutDrill have a very easy maintenance that consist in the substitution in one of its two modules; Rotor or Tractor (jaw holder) that weigh very few and can be deliver quickly. Our Por-sale service do not repair the pieces, that are substituted or provided complete, to warranty the perfect fuction, but we provide the spare parts necessary when is required. Any replament unit had to be sent freight paid, to the address we will give after inform technical service by phone or WhasApp to 34 693215339





# Smart RiveDrill in 60 countries







# The United States of America

## The Commissioner of Patents and Trademarks

*Has received an application for a patent for a new and useful invention. The title and description of the invention are enclosed. The requirements of law have been complied with, and it has been determined that a patent on the invention shall be granted under the law.*

*Therefore, the*

*United States Patent*

*is granted to the person or persons having title to the same, for the term of years from the date of the filing of the application, for the use of the same, subject to any conditions or requirements of the law.*



*A. Todd Pichini*

Commissioner of Patents and Trademarks

*Pandra Morton*

Attest





# Smart RiveDrill

## In the World



# RiveDrill

## In the World



[www.rivedrill.es](http://www.rivedrill.es)



**You can, buy, sell, use, repair or know,  
RiveDrill, anywhere in**  
**[nuria.andrea@rivedrill.net](mailto:nuria.andrea@rivedrill.net)**







# Smart RiveDrill



Máquinas Andrea, S.L.  
At your service

Since 1966



## Smart riveting machine for drilling machine

[www.rivedrill.com](http://www.rivedrill.com) [www.rivedrill.net](http://www.rivedrill.net) [www.rivedrill.es](http://www.rivedrill.es) [www.rivedrilliberica.com](http://www.rivedrilliberica.com)  
Fax. + 34 913526577 - [info@rivedrill.com](mailto:info@rivedrill.com) - WhatsApp 34 693215339

Prohibido la reproducción total o parcial. Todos los derechos reservados. Dibujos registrados. Modelos patentados. Marca Registrada.





Smart **RiveDrill**



**Holes and rivets together forever**

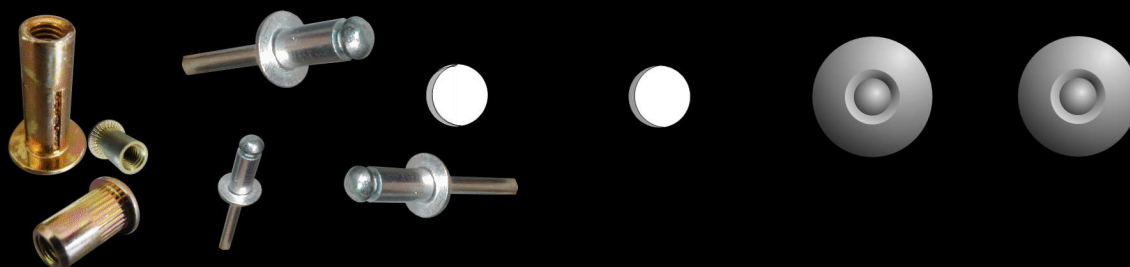

**RiveDrill and drill together,  
strength comes in numbers**

**Máquinas Andrea, S.L.**  
At your service

Since 1966